

Stanley, WI -- East Business Park

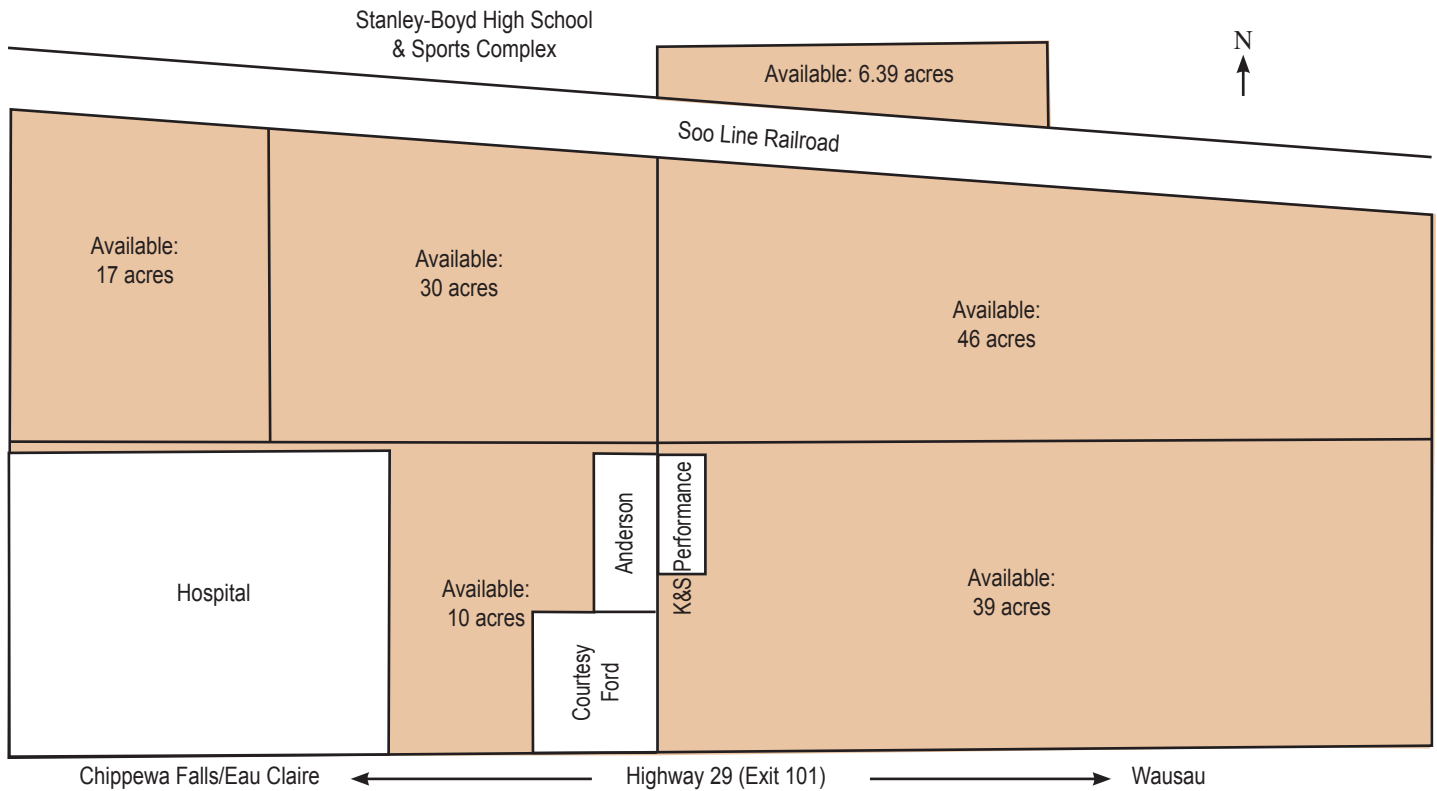

Site Specifications

SITE INFORMATION

Available Acres	148
Zoning	Urban/ Transitional

TRANSPORTATION

Nearest major highway	WI State Hwy 29 (Expressway)
Distance to nearest highway	Adjacent
Lanes	4
Nearest comm. airport	Eau Claire
Distance to airport	30 miles
Rail provider	Canadian National
Rail siding	Adjacent

UTILITIES

Electricity supplier	Clark Electric Cooperative
3-phase electric	Yes
Gas supplier	WE Energies
Municipal water	Yes
Municipal sewer	Yes
Stormwater	Yes

TELECOMMUNICATIONS

Fiber optics	Yes
Telephone	CenturyLink Charter

MEDICAL

Aspirus Hospital	0 mi
------------------	------

INCENTIVES

Multiple Local, State, and Federal funding opportunities	Regional Business Fund
	WI Financing & Tax Credit Programs
	WHEDA/USDA/WBD
	TIF
	Labor training & others
	WEDC

INDUSTRIAL PARKS

Second park located west of city, 200 acres
Zoned heavy industrial (map on reverse side)

MAJOR EMPLOYERS NO. OF EMPLOYEES

Stanley Correctional Facility	380
School District of Stanley-Boyd	160
Ascension Our Lady of Victory Hospital	152
Film Tech	49
Ace Ethanol	40
Archer Daniel Midland (ADM)	20

TERMS

Land sales based on company investment and job creation

Municipal ownership

CONTACTS

Sheila M. Nyberg
Executive Director
Clark County Economic
Development Corporation
301 N. Main St.
P.O. Box 236
Loyal, WI 54446
Phone: 715-255-9151
Fax: 715-255-9153
sheila@clarkcountyedc.org
www.clarkcountywi.org

Nicole Thiel, Clerk/Treasurer
353 S. Broadway St.
P.O. Box 155
Stanley, WI 54768
Phone: 715-644-5758
Fax: 715-644-5705
clerk@stanleywisconsin.us
www.stanleywisconsin.us

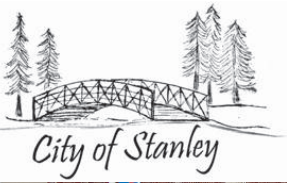

Stanley -- live, work, & play well!



BROADWAY HOME DECOR AND FLORAL



ACE ETHANOL



CHAPMAN PARK



COURTESY FORD

City of Stanley
 353 S. Broadway St.
 P.O. Box 155
 Stanley, WI 54768
 715-644-5758
www.stanleywisconsin.us



ASPIRUS HOSPITAL

“The Best of Times Start in Stanley”. Strategically located halfway between Green Bay and Minneapolis/St. Paul, along Highway 29 in west central Wisconsin, Stanley is a warm-hearted community of 3,378 and straddles Chippewa and Clark counties. It offers a fine balance of businesses, products, services, housing, good schools, and varied recreational opportunities.

Stanley visitors can access conveniently-located motels and choose from a number of restaurants and specialty food and beverage

options. It has one of the few remaining historic movie theaters in the country, as well as shopping, professional and financial services in a safe, walkable downtown.

Otter Lake recreation area is seven miles north of Stanley, and is just

one of the areas offering fishing and hunting opportunities and recreational trails. The 10,500 sq. ft. Stanley Area Historical Society Museum draws visitors from near and far, and the community has a pool and fitness center at the high school.

Travel Time to Stanley, WI

To and from Stanley	Miles
Eau Claire, WI	35
Wausau, WI	66
Minneapolis/St. Paul, MN	120
Madison, WI	178
Green Bay, WI	159
Milwaukee, WI	250
Chicago, IL	319

